

north **WALTON BLVD.**

N WALTON BLVD/ Access-Aesthetics-Activity

- Welcome travelers with gateway features at approximately NW 14th Street.
- Promote economic development with commercial activity nodes at both Tiger Boulevard/NW 12th Street and Walmart Buildings/NW 5th Street.
- Improve walk-ability by connecting adjacent neighborhoods with sidewalks and tree-lined streets.
- Reflect the city's art culture with public art installations throughout the corridor.
- Inspire socialization with inviting and beautiful public spaces.
- Encourage mixed use developments that provide both housing and commercial spaces.

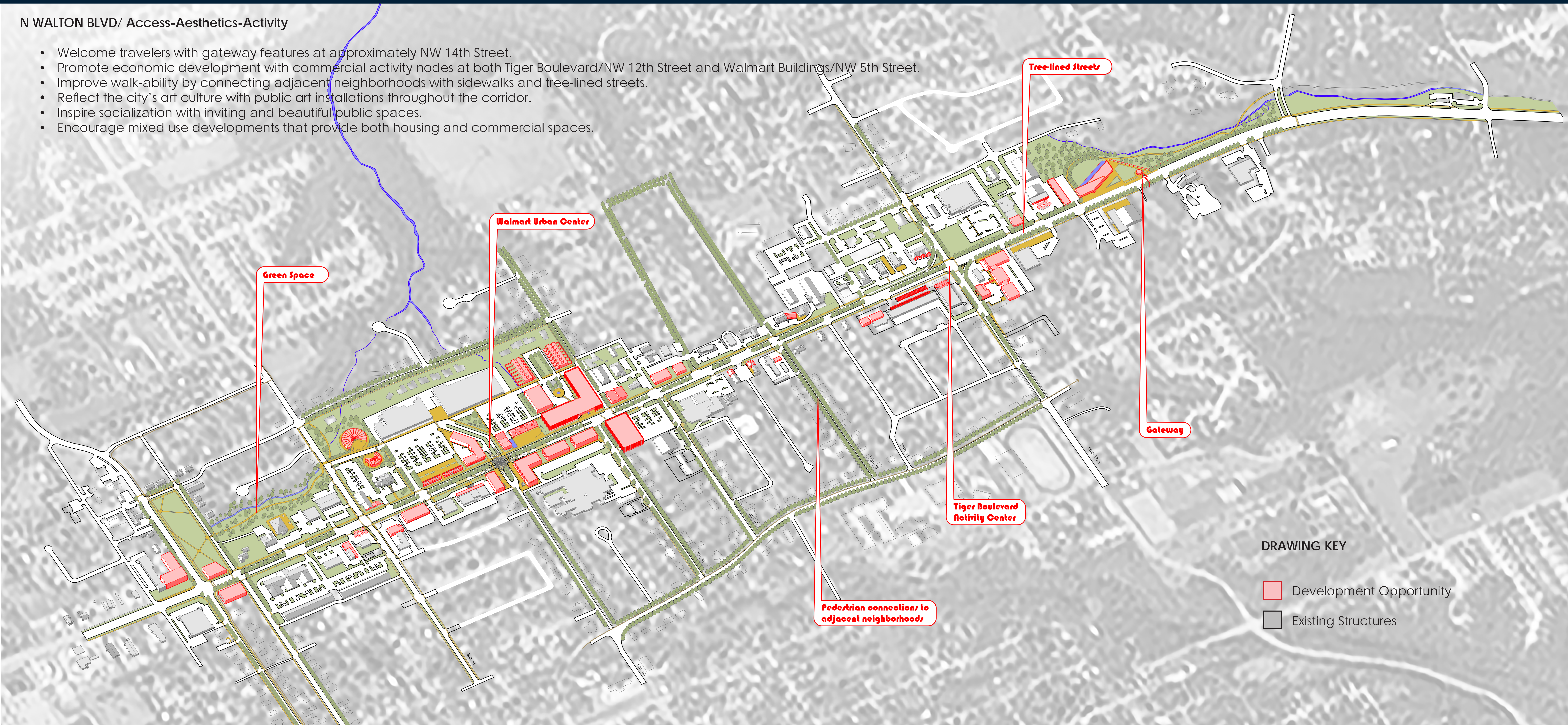

GATEWAY

welcome

- NORTH GATEWAY
Trail-head
- Welcome travelers with a unique and easily recognizable gateway into Bentonville in the area of NW 14th Street.
 - Establish a trail-head that is beautifully landscaped, displays public art, and serves as an inviting public space.
 - Provide amenities, including restrooms, outdoor seating, bicycle parking, and informational kiosks about the trail system, the city, and northwest Arkansas.

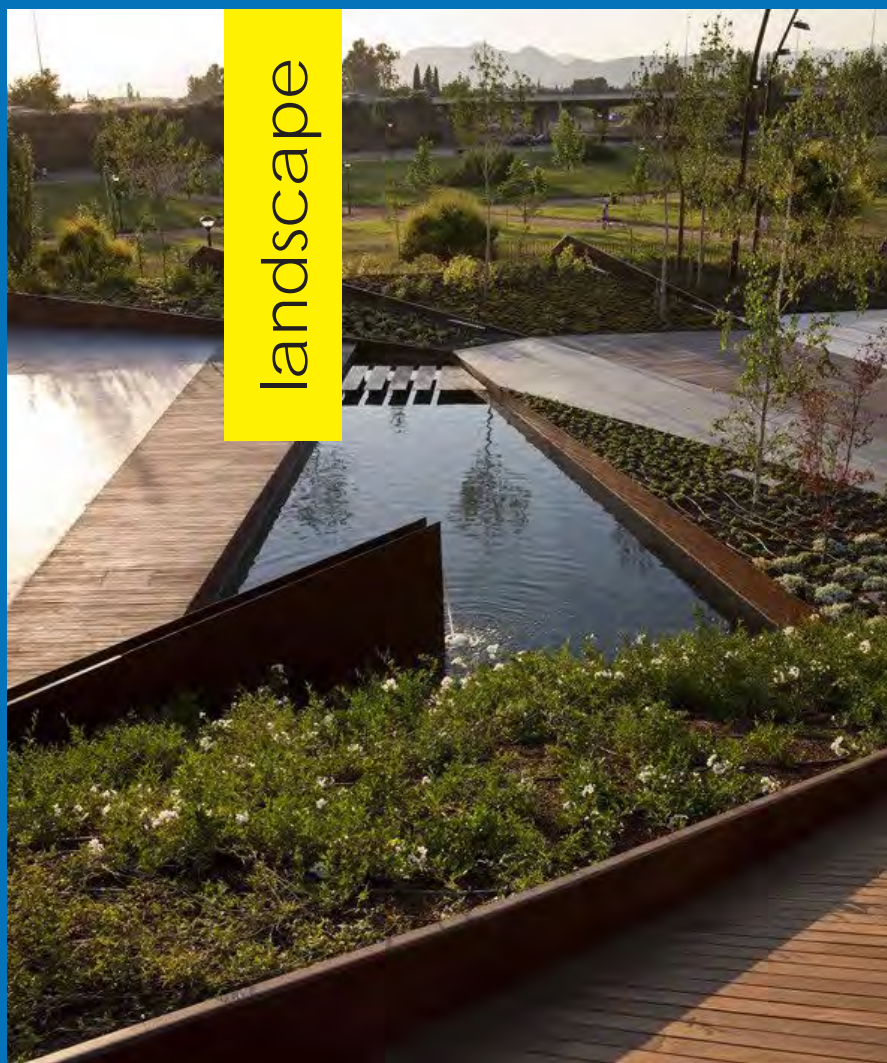

URBAN center

Hight-Jackson Associates PA
architecture • engineering • planning • interior design

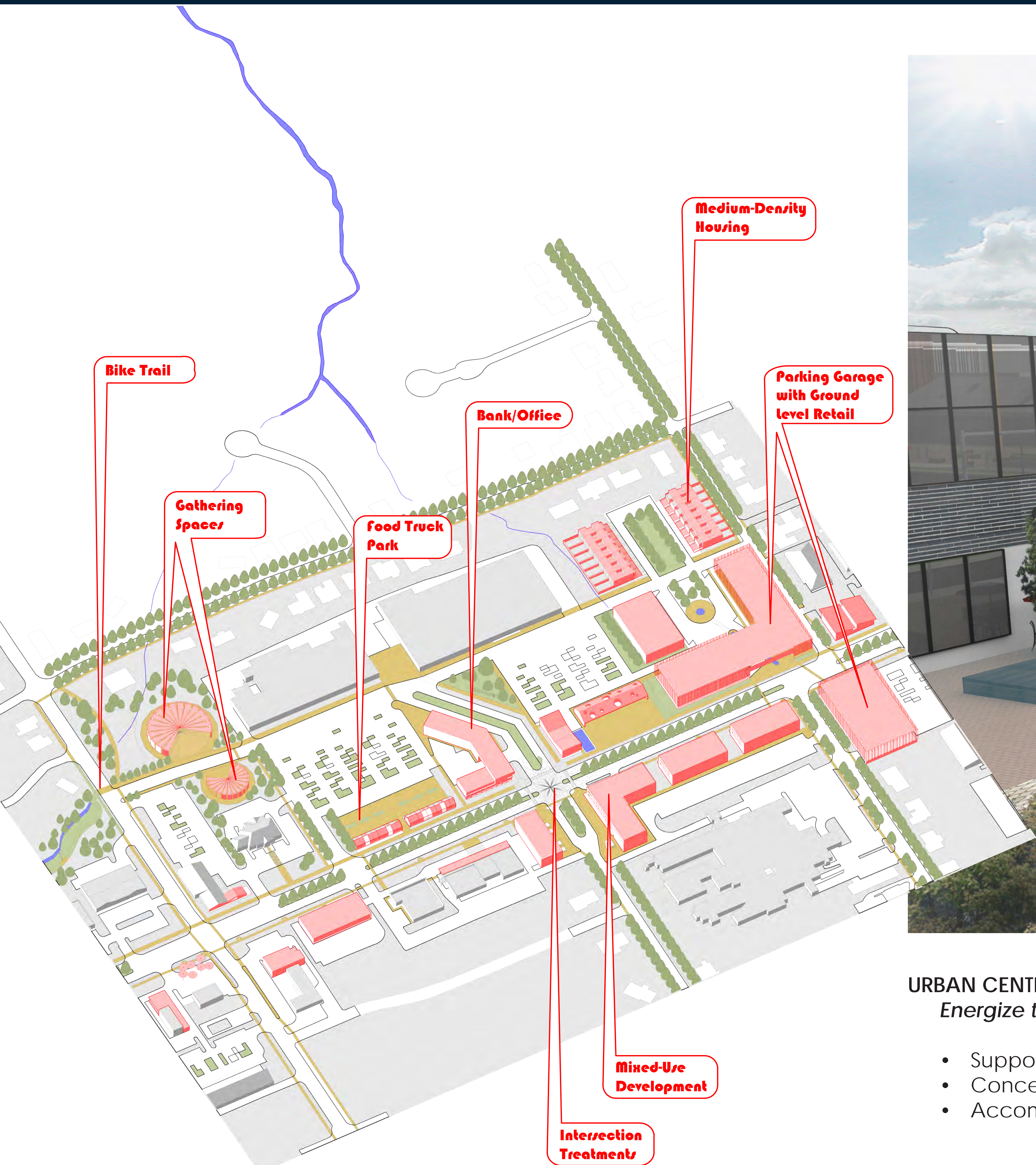

STREETScape ENHANCEMENTS
concept view looking west

URBAN CENTER - Walmart Activity Center *Energize the private realm*

- Support the large number of employees in the area with restaurants and retail within walking distance.
- Concentrate commercial activity with greater building density and mixed uses.
- Accommodate future parking needs with parking garages rather than expansive parking lots.



open air market



mixed use development



street edge



public seating



outdoor cafe

PUBLIC amenities



PARKING LOTS

Activate spaces day and night

- After hours, energize large, empty parking lots with food trucks, open air concerts and community markets.
- Reduce stormwater runoff and water contamination by introducing pervious paving.
- Beautify existing parking lots with landscaping and help reduce the heat island effect with shade trees.

STREETSCAPES AND PUBLIC SPACE

Introduce green infrastructure

- Encourage and support alternative transportation modes with sidewalks, bicycle parking, transit stops, and outdoor seating.
- Inject sustainable practices with green-space and rain gardens between sidewalk and back of curb.
- Make public spaces more human-scale with shade trees and landscaping.
- Help orient visitors with way-finding signage throughout the district.
- Reflect Bentonville's art culture with public art installations.



RENEWED streets

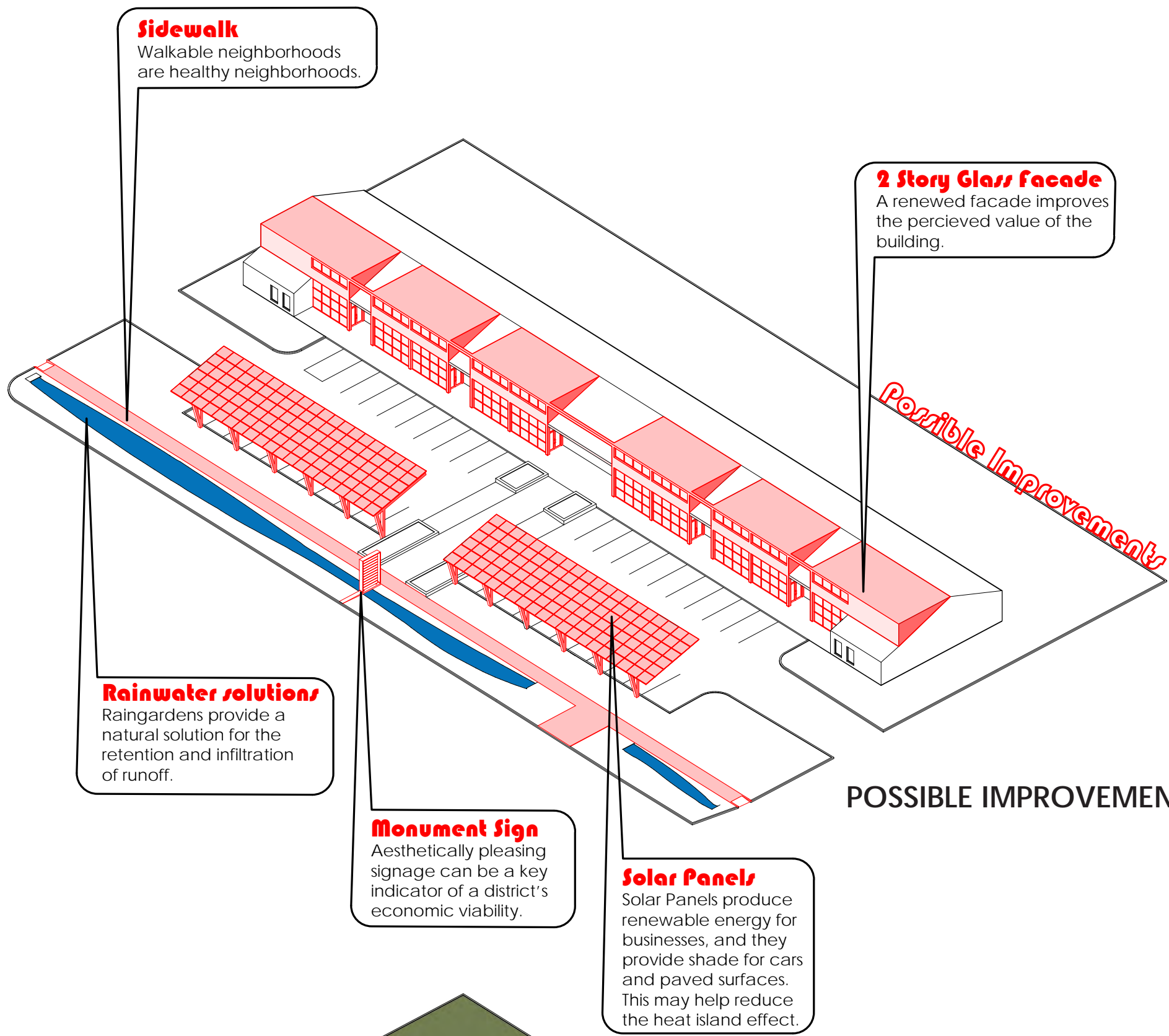
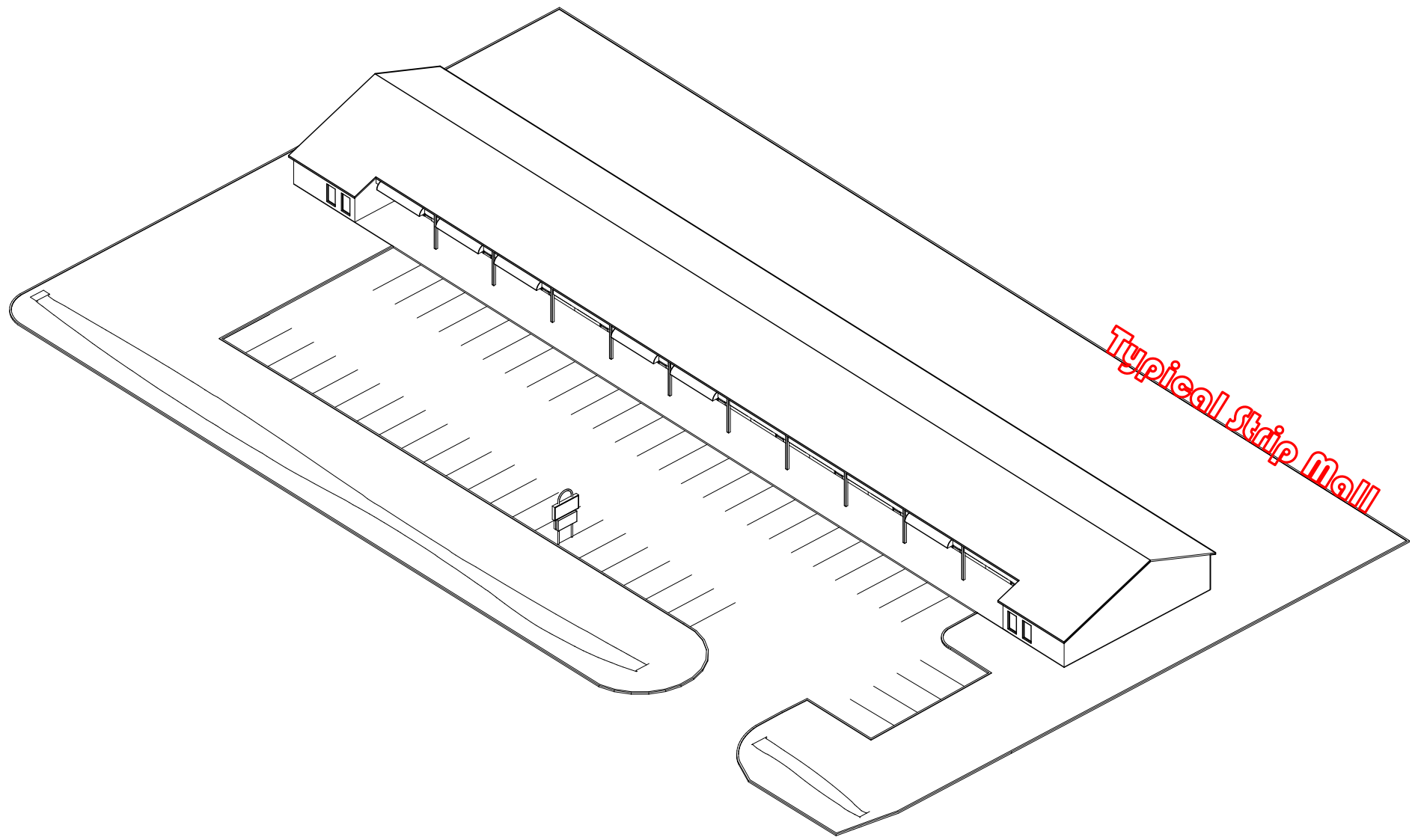

TIGER ACTIVITY CENTER
Beautify the public realm

- Promote walk-ability with continuous wide sidewalks and highly visible crosswalks.
- Inject sustainable practices with green-space and rain gardens between sidewalk and back of curb.
- Reduce visual impact of overhead utility lines with tree density and monument signs to draw the eye downward.
- Revive older buildings with modern facade renovations.
- Enhance aesthetics with foundation and parking lot landscaping.
- Provide easy pedestrian access between sidewalk and buildings.

